

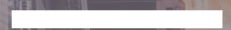

MICROSENS



SBR
Savunma



Microsens

- German manufacturer founded in 1993
- Competence in manufacturer of Ethernet switches, converters and xWDM platforms based on fibre optic
- I+D and production in the headquarter in Hamm and Neu-Isenburg(Frankfurt). Offices in France, Poland and Dubai
- Technology partner of well known Manufacturer like Siemens, Alcatel-Lucent, Dräger Medical, Mobotix...
- More than 1 Mio. installed active ports all over the world
- Since 2020 Microsens belongs to the Zech Group

The Company



SBR
Savunna

**+25 years
Experience**

**+110
Employees**

**Worldwide
Projects**

MICROSENS

Our End-users



ENTERPRISE NETWORKS



INDUSTRIAL SOLUTIONS



OPTICAL TRANSPORT



SMART Building Solutions



- FTTO – Alternative concept to SCN
- BFOPs – Basic Fibre Optic Products
- Components for harsh environments
- Profi Line for professional installations
- Entry Line for basic installations
- Enterprise Interconnection
- Solutions for telecommunication companies
- Transmission from 40 to 100G
- RAMAN Amplifier
- Building automation based on Ethernet Network

Product groups

Fiber To The Office (FTTO)

Structured Cabling Network

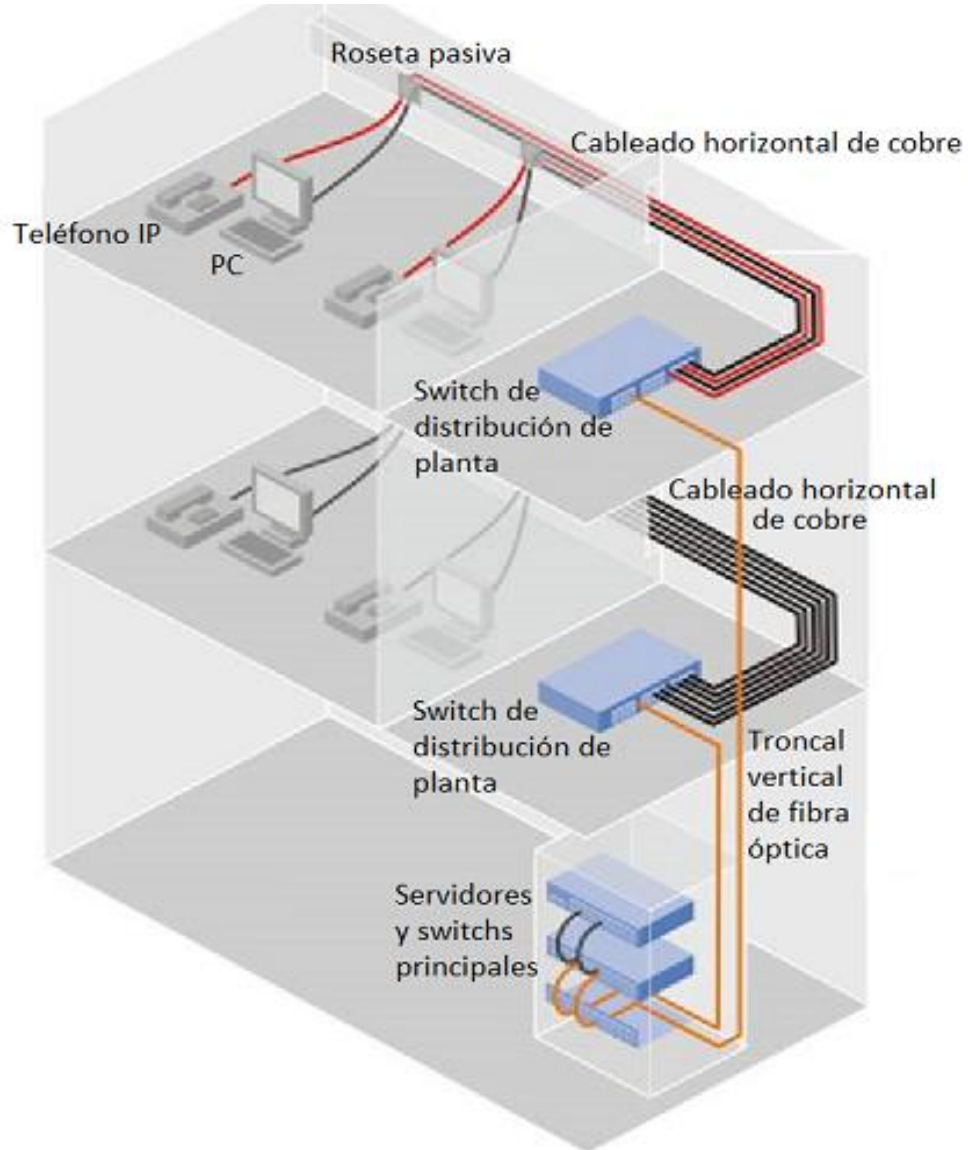

Fiber To The Office (FTTO)

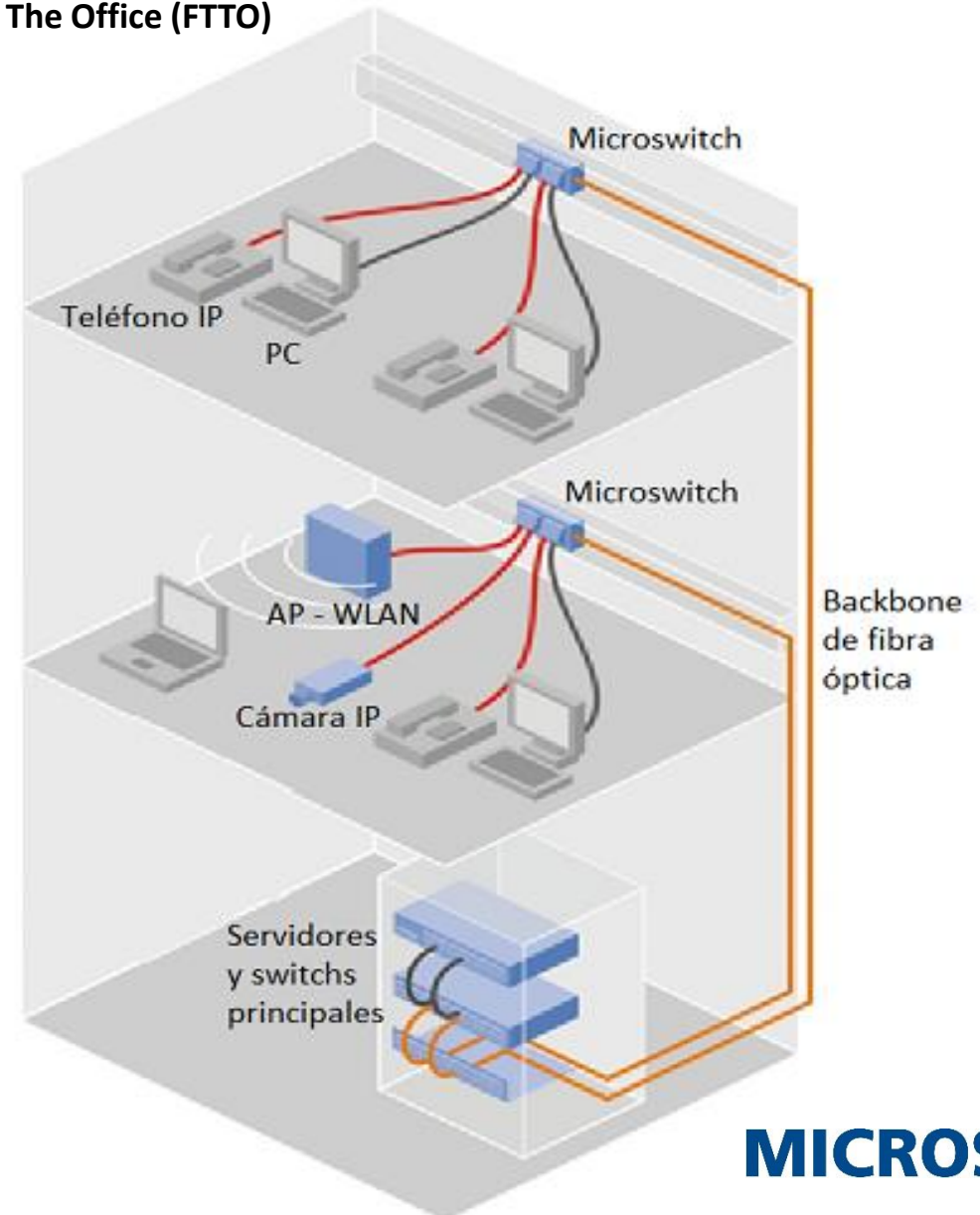

MICROSENS

FTTO: Microswitch 6th Generation

Full Gigabit Ethernet →

Energy Efficient Ethernet →

Power Over Ethernet+(30 W) →

Compact design 45x90 mm →

Fanless Design →

Professional Management System nmp →

MicroSD card for storing firmware and configuration →

For individual use in star, ring and mixed topologies →

Also with extended temperature and DIN Rail Mounting →

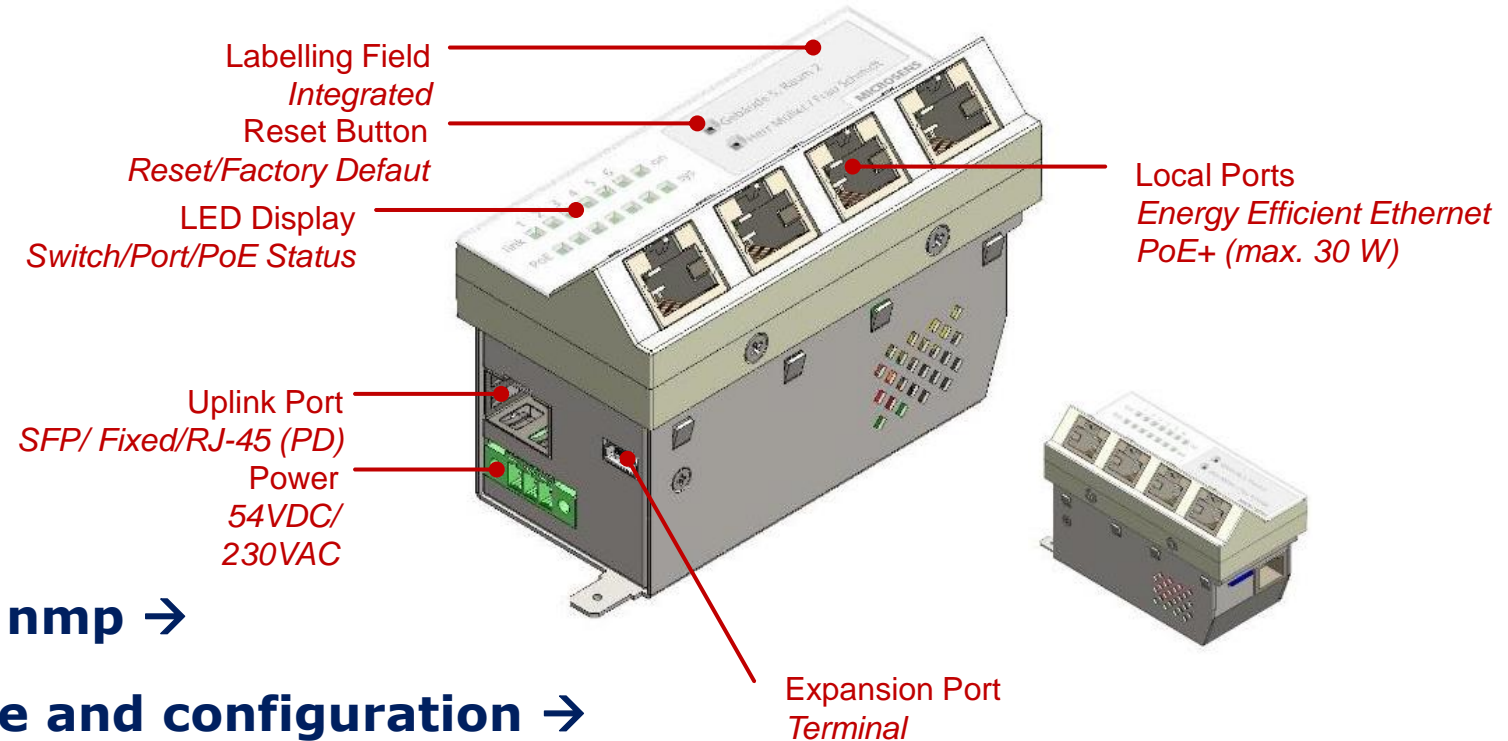

Microsens Generation 6



FTTO switches for temperature controlled environments

Higher flexibility through a wide range of variations

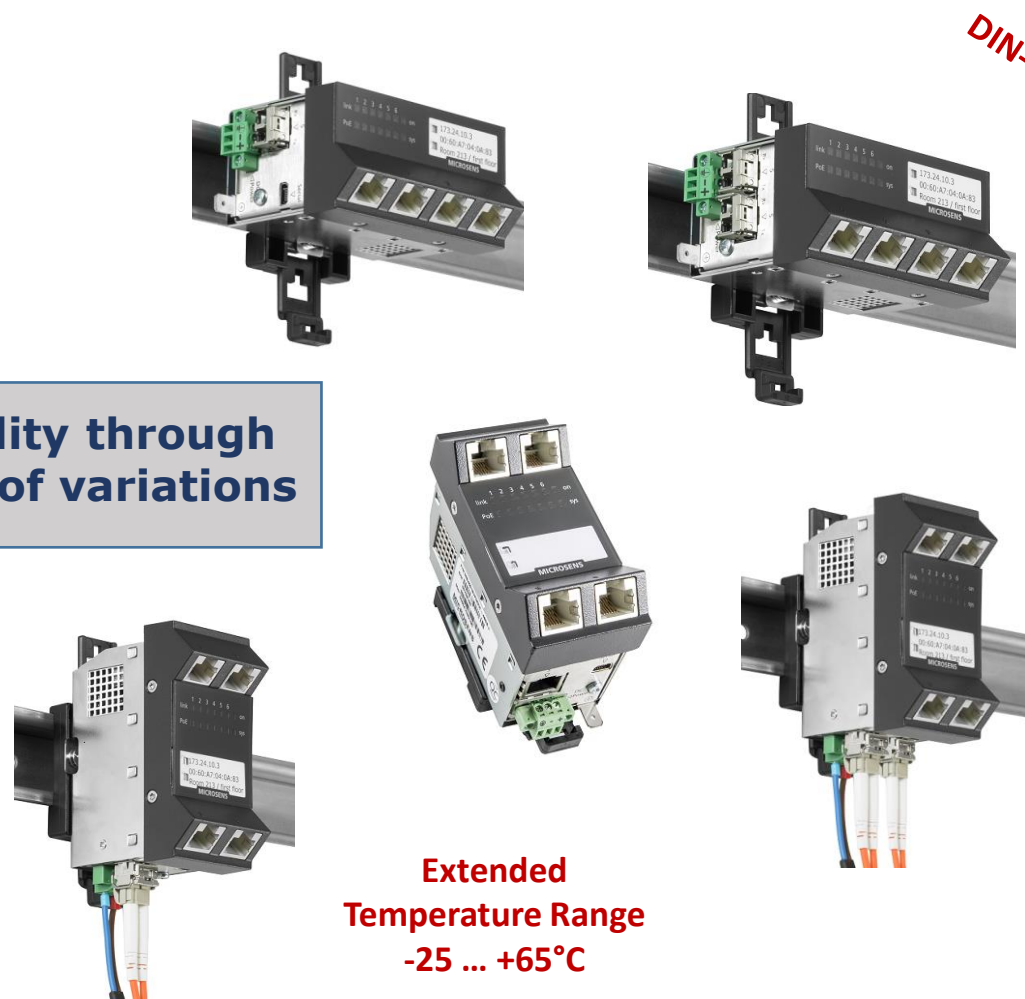

DIN-Rail mounting

**Extended Temperature Range
-25 ... +65°C**

Ruggedized FTTO switches with DIN-Rail mounting option and extended temperature

FTTO: Microswitch Variation

Microswitch for indoor use

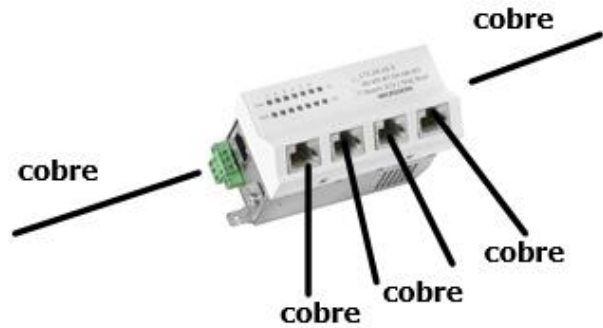

MS450186PM-48G6+

Gigabit Ethernet Micro-Switch 45x45,
4x10/100/1000T with 2x 10/100/1000 Base-T Up-&
Downlink ports

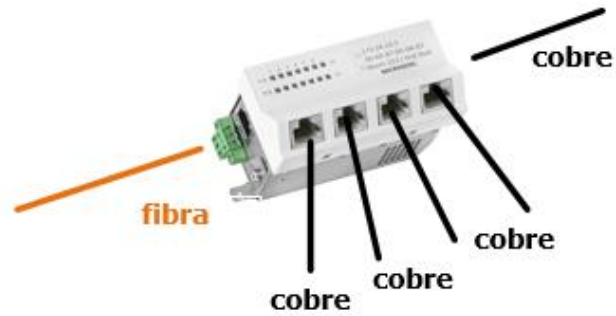

MS440209PM-48G6+

Gigabit Ethernet Micro-Switch 45x45,
4x10/100/1000T with 1x1000Base-X SFP Uplink
and 10/100/1000T downlink

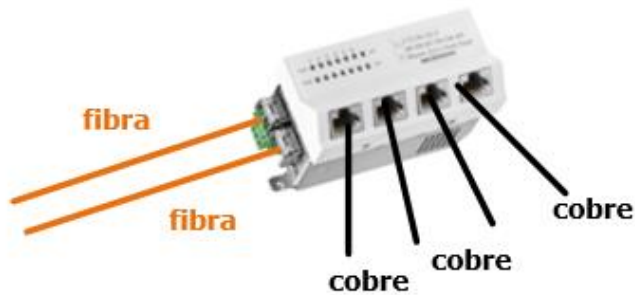

MS440207PM-48G6+

Gigabit Ethernet Micro-Switch 45x45 horizontal
design, 4x10/100/1000T with 2x SFP-Uplink
100/1000X

MICROSENS

Fiber to The Office: Ruggedized Switch

Microswitch for outdoor use



MS440219PMXH-48G6+

Gigabit Ethernet ruggedized Micro-Switch, 4x10/100/1000T PoE+, with 1x SFP-Uplink 100/1000X (dual speed), horizontal design, DIN-Rail holder, extended temperatura(-20 to +65°C)

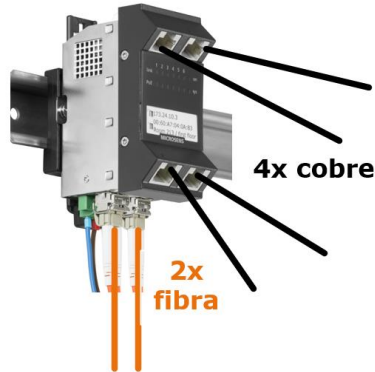

MS440217PMXH-48G6

Gigabit Ethernet ruggedized Micro-Switch, 4x10/100/1000T PoE+ with 2x SFP-Uplink 100/1000X (dual speed), horizontal design, DIN-Rail holder, extended temperatura(-20 to +65°C)



MS450187PMXH-48G6

Gigabit Ethernet ruggedized Micro-Switch, 6x10/100/1000T 5x PoE+/PD, horizontal design, DIN-Rail holder, extended temperatura(-20 to +65°C)



MICROSENS

Fiber to The Office: Ruggedized Switch

Outdoor boxes IP66/67 for Microswitch ruggedized



MICROSENS

Exampel: Star Topology

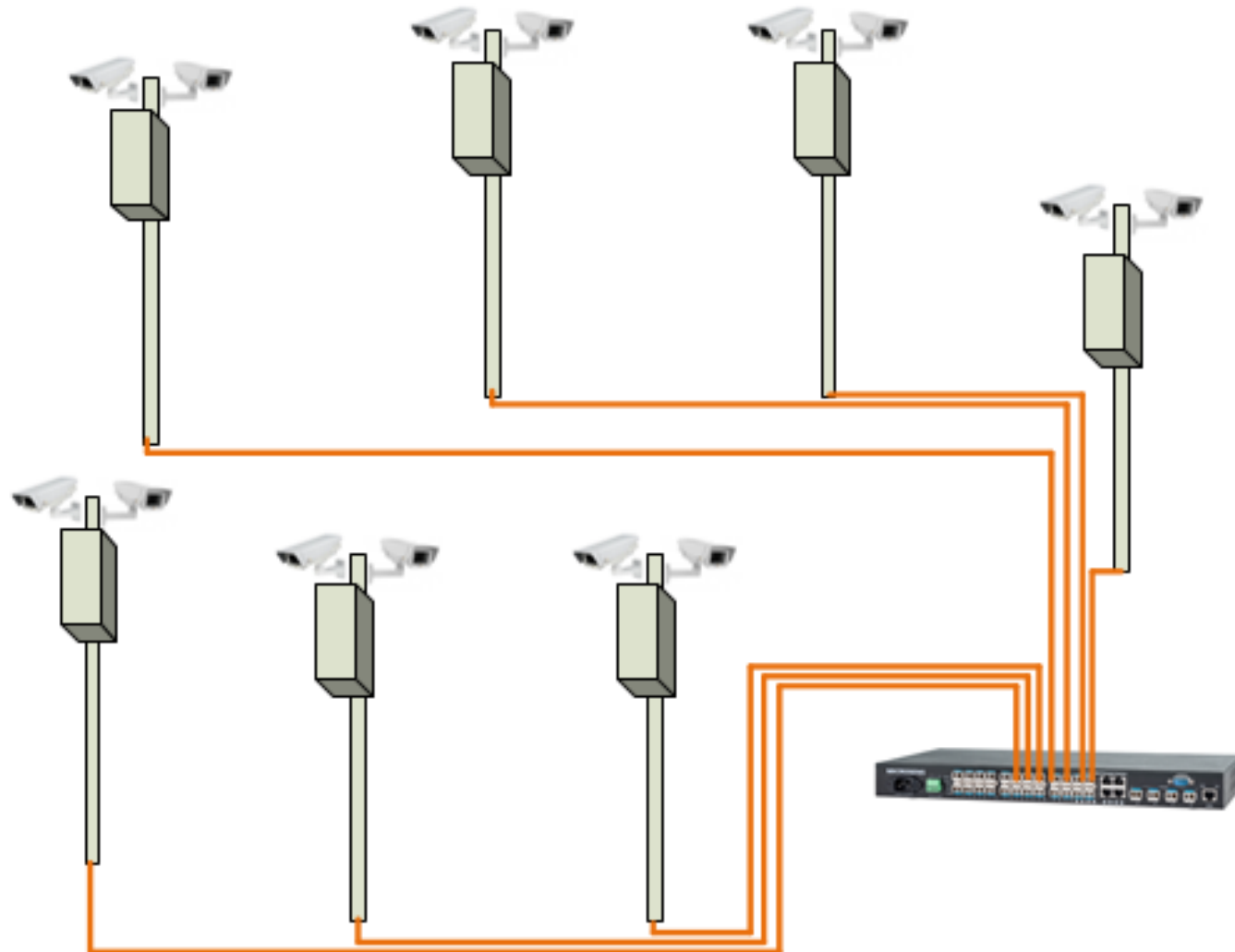

MS440219PMXH-48G6+

Ruggedized Switch: Configuraciones

Example: Redundant Star Topology

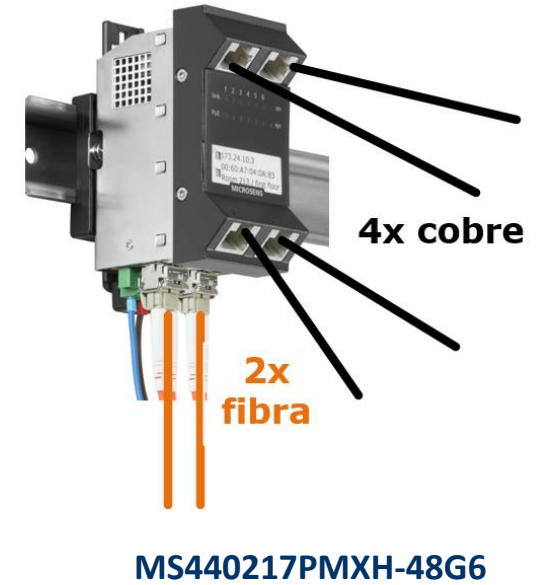
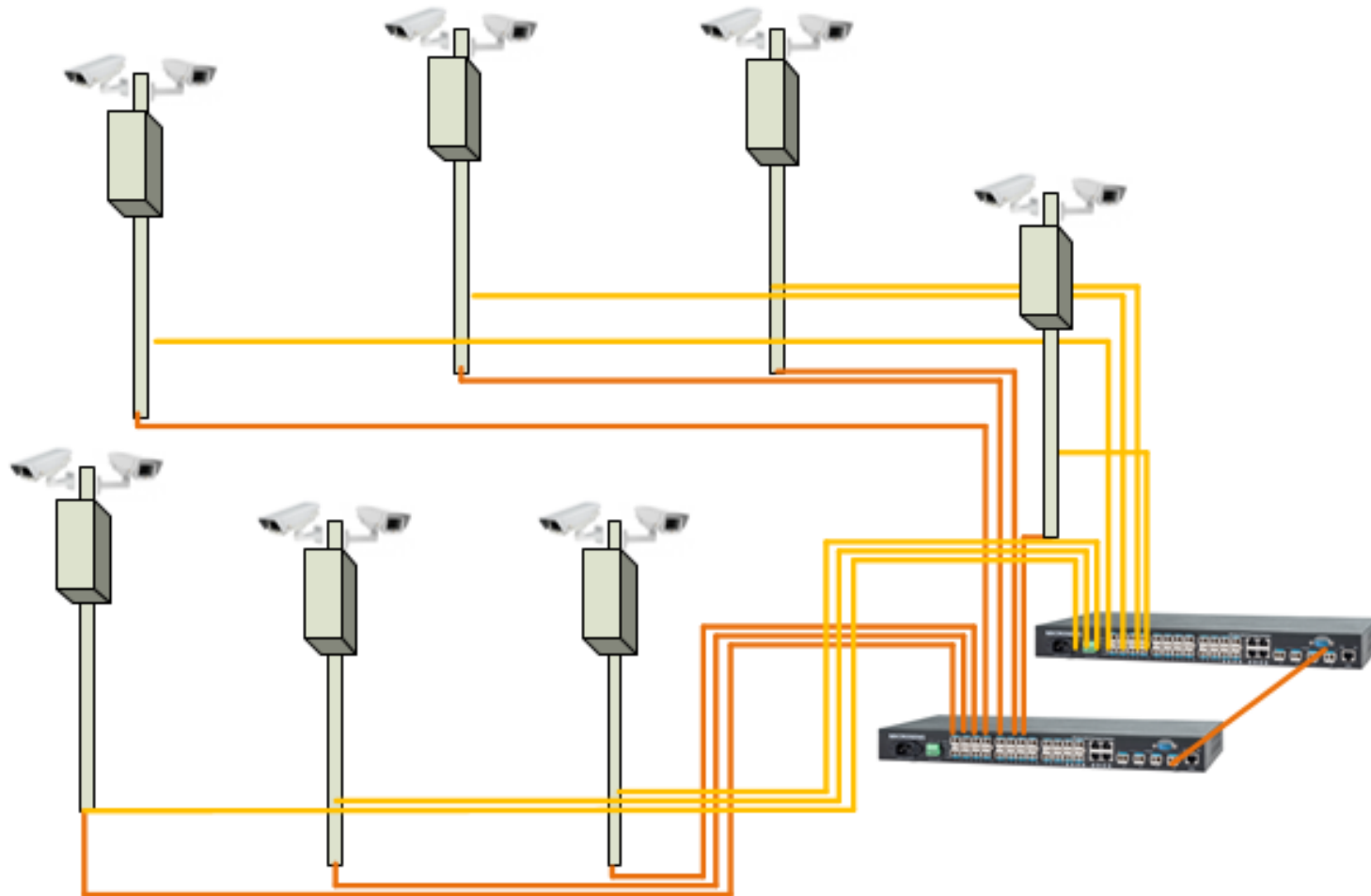

Ruggedized Switch: Configuraciones

Example: Redundant Fibre Ring Topology

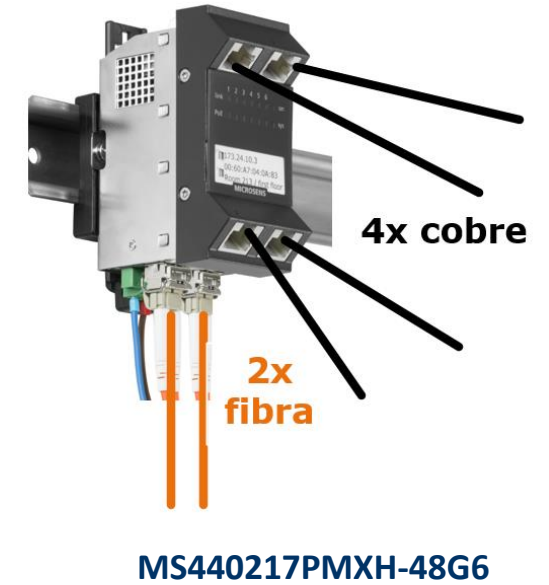
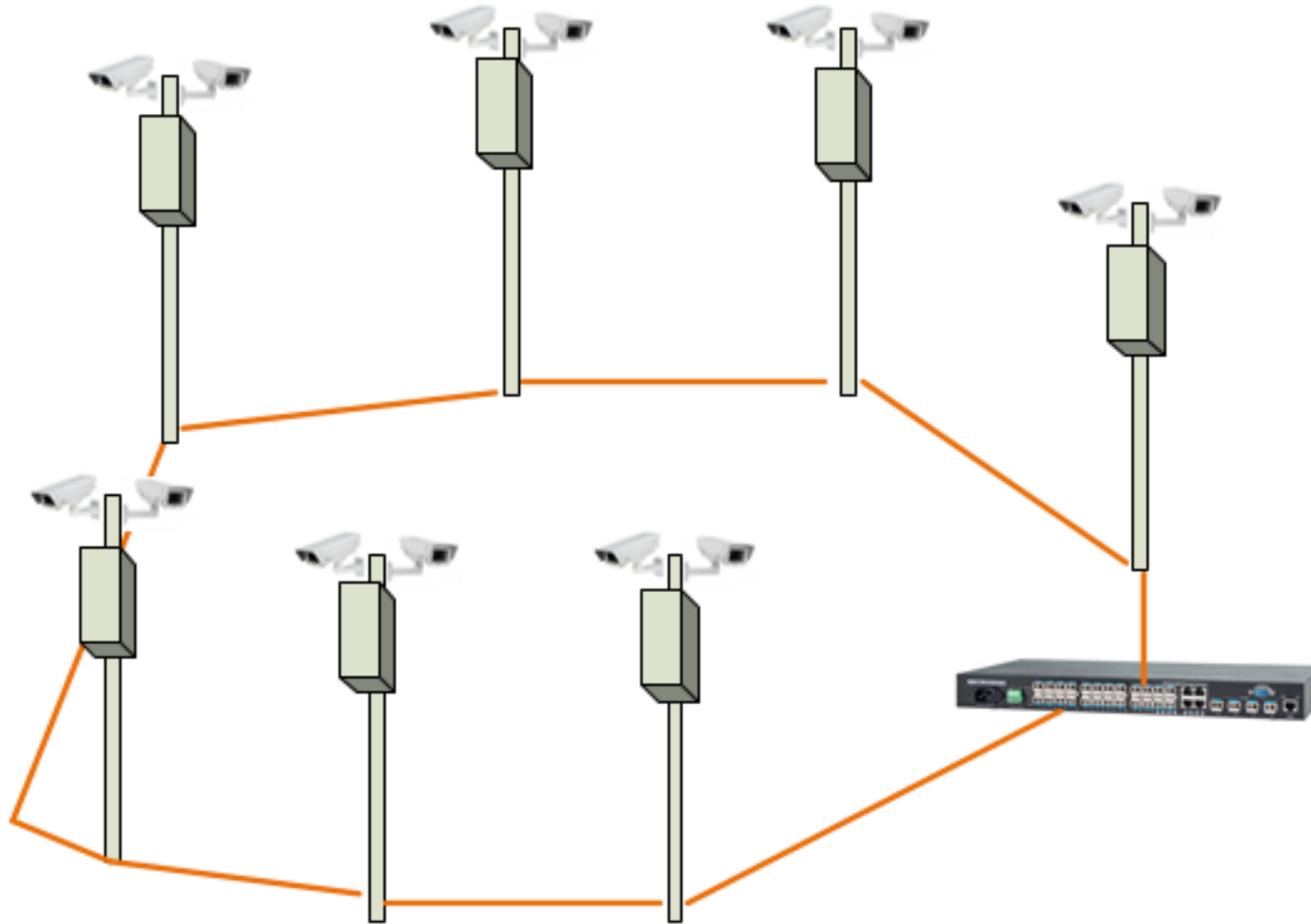

MICROSENS

Ruggedized Switch: Configuraciones

Example: Redundant Fibre/Copper Ring Topology

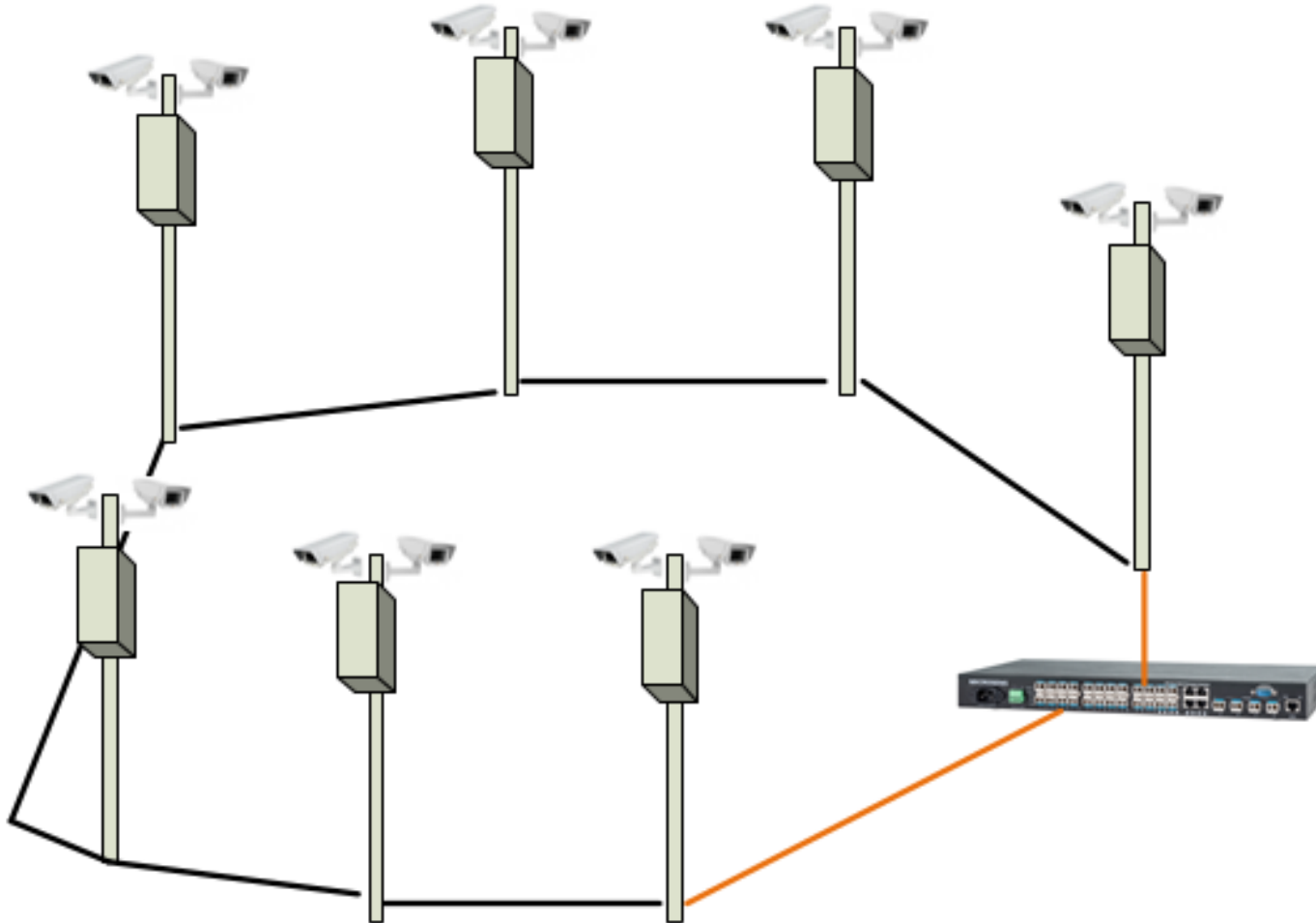

MS450187PMXH-48G6

MICROSENS

Fiber to The Office: Powering

Power Supplies

MS700701/MS700710

Power Supply for Microswitches with PoE/PoE+ functionality, 60W, 54 VDC



MS700750

Power Supply 45x45 for Microswitches for installation in cabletrunk funcionalidad for PoE/PoE+ functionality, 70 W, 54 VDC



MS700458

DIN Rail mounting power supply 480 Watt 48 VDC/10 A, input voltage 93-264 VAC, screw terminals, temperature range -40°C..71°C



MS70087x

19" 1U Power Supply, 3 module 850W/54VDC for max 2.550W with management (SNMP included)



MICROSENS

Powering Options

Distributed Power Supply

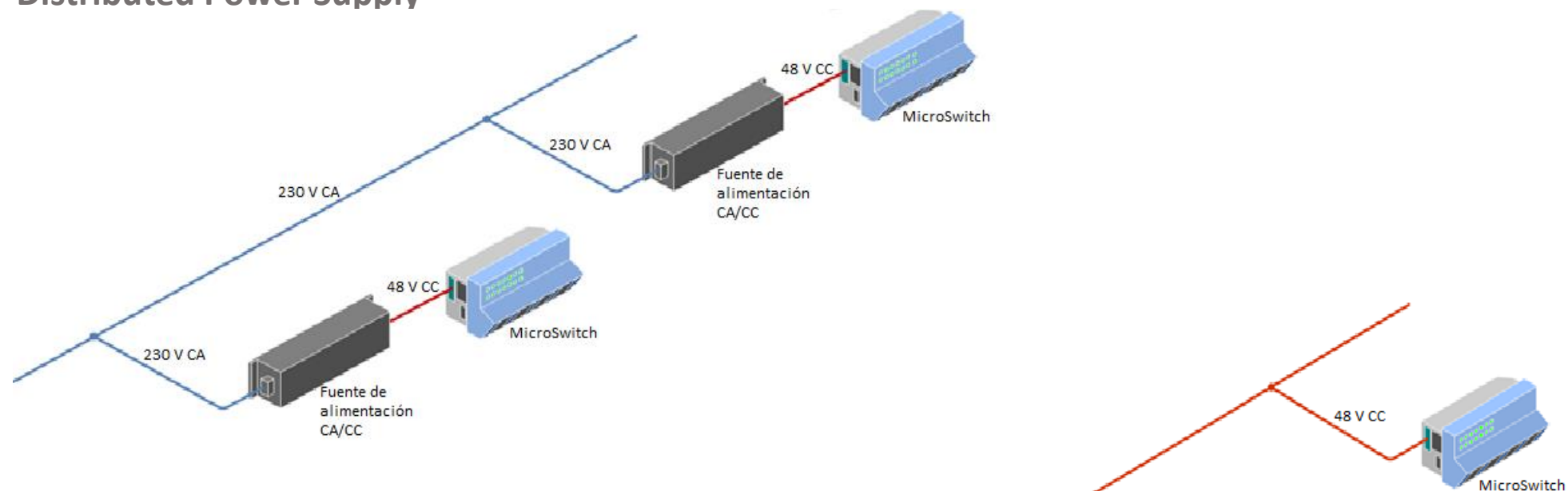

Centralized Power Supply

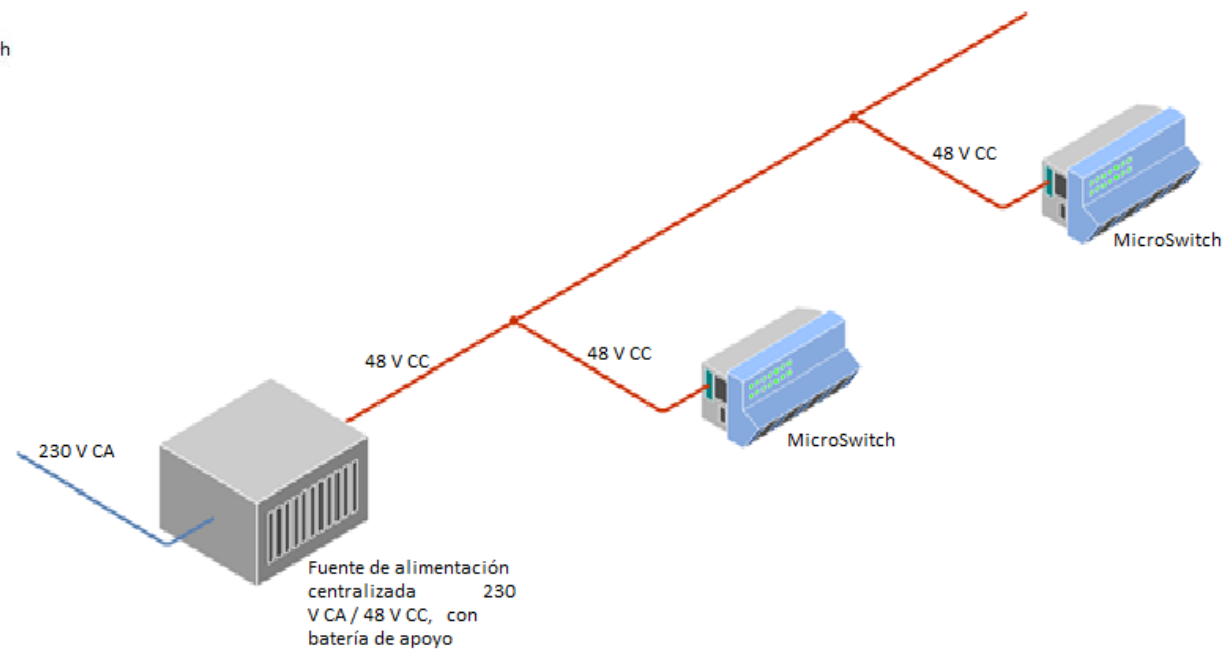

Fiber To The Office – Network Example

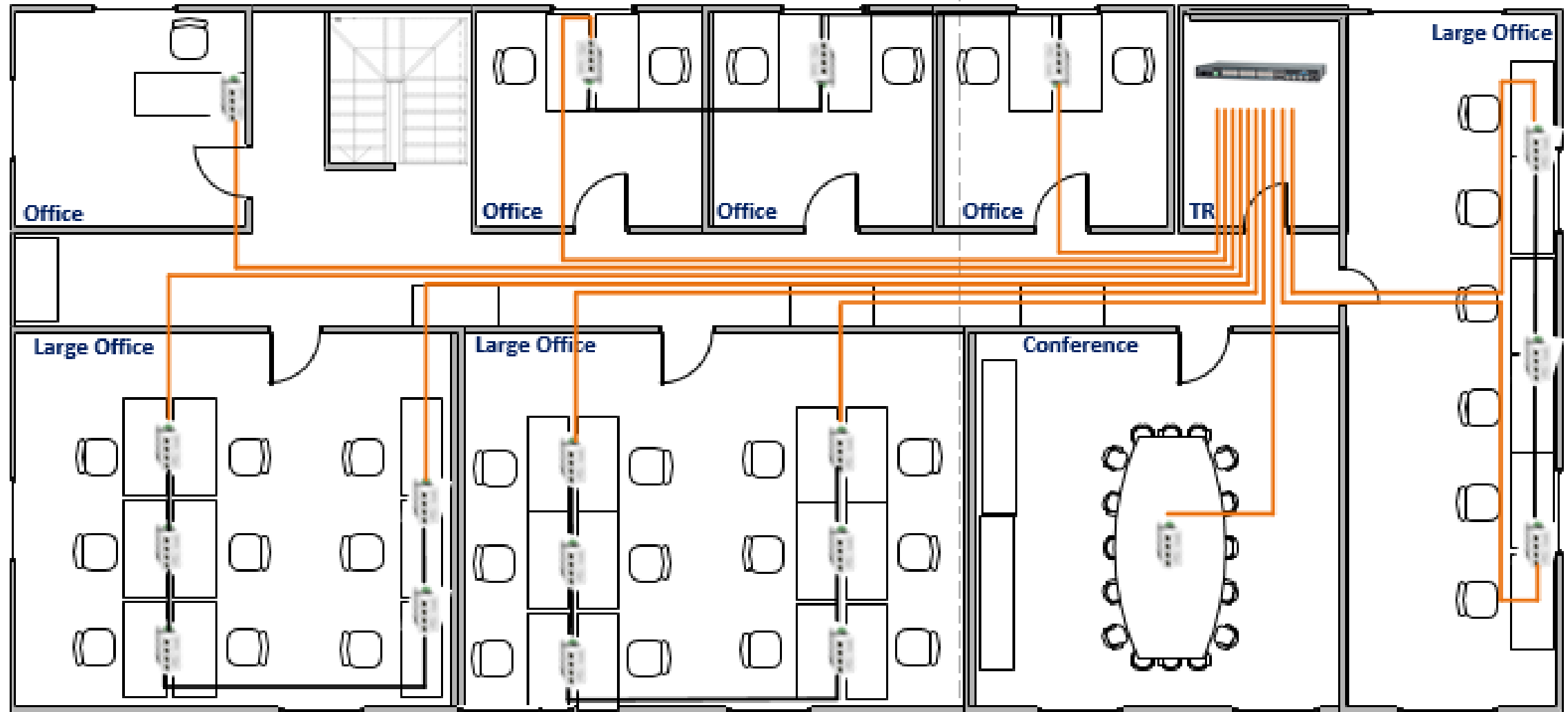

Fiber To The Office – Network Example

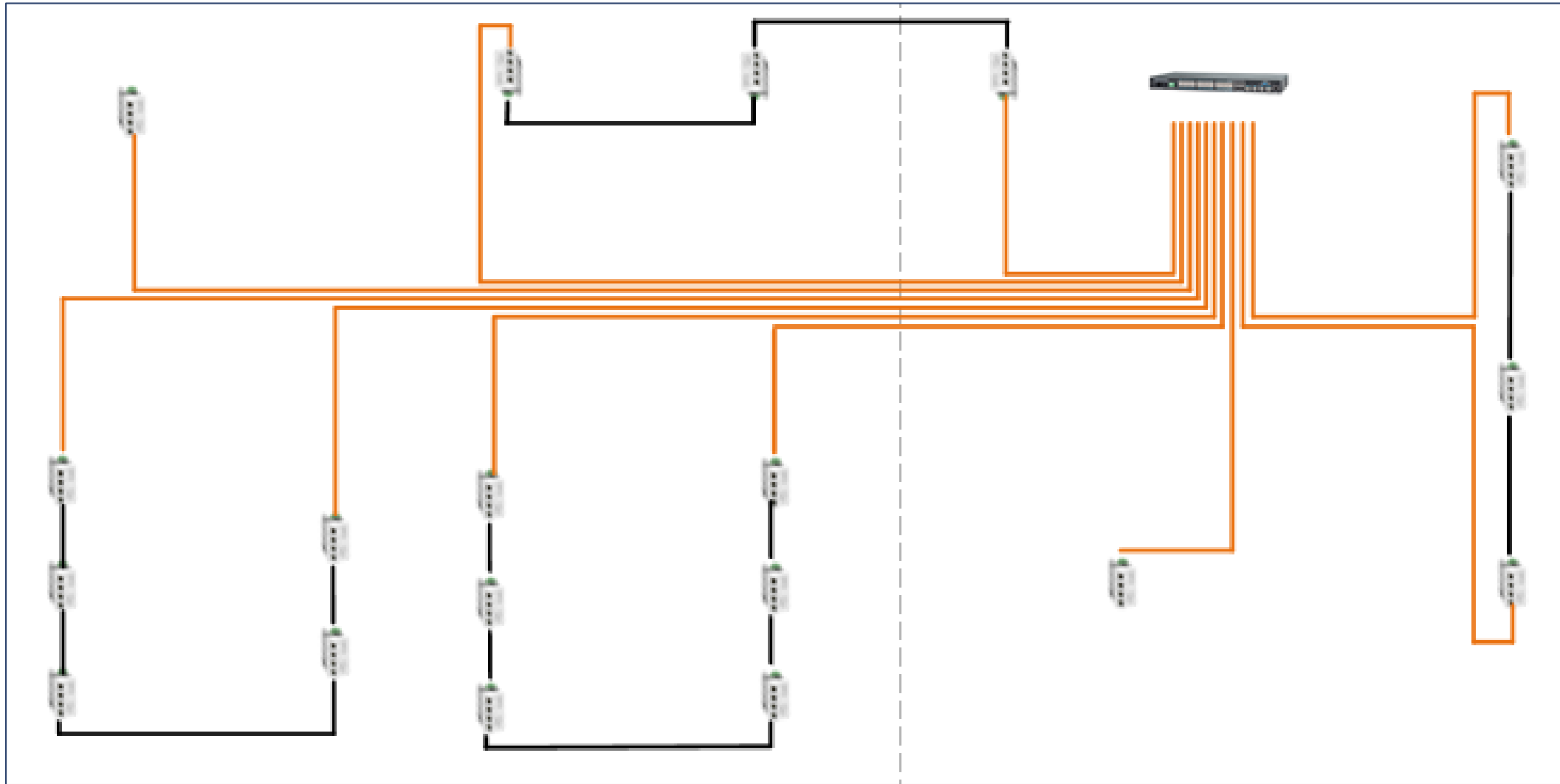

Fiber To The Office



Company - Industrial Series

Profi Line Modular



- Highest Performance, (25 GBE ports, PoE+)
- Expansion tailored to needs
- Fault tolerant through Ring Technology
- Network Security

Profi Line



- Robust and reliable
- For fail sensitive applications
- Certifications for Rail and Power Substations
- Ring Topology
- Network Management

Entry Line



- Basic Solutions
- Bridges, Switches, Device Server
- without Management
- Cost-effective, fast delivery

Entry Line



- Basic Solution without Management
- Bridges, Converter, Switches
- Injectores for PoE up to 90 W
- Plug and Play
- On Stock

Profi Line G6



- For critical Infrastructures
- Extended temperatur up to + 85°C
- Management system profesional nmp
- Star- Ring- Topologies
- Security functions
- Certification for „Railway“ and „Power Substations“

Profi Line Modular Series



Hardware-Platform

- Latest switch technology with Energy-Efficient Ethernet
- Modular design up to 25 GBE ports, up to 8 GBE Fiber Ports
- Power-over-Ethernet+ (802.3at) on all copper ports (max. 200W)
- SD card for firmware & configuration
- Solid metal chassis, clear port layout
- Temperature range -40..+75°C
- Redundant power supply input
- I/O Ports: 2x in, 2x out
- Modular Expansion Slot (port numbers, I/O, Services etc.)

Key Features

- Full Gigabit Ethernet
- Modular Design (Expandable)
- 13x RJ-45 Ports
 - PoE+ (30W) per port
 - Energy Efficient Ethernet
- 4x Dual Media SFP (SC optional)
- 1x PD port to power device
- High performance CPU
 - Open source platform (Linux OS)
- Ruggedized Housing

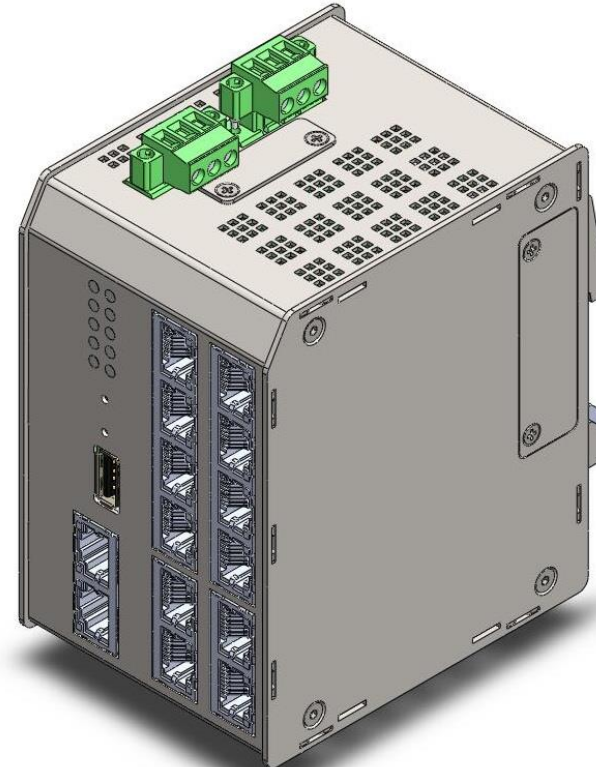

Profi Line Modular – Switch Generation 6

Base Unit

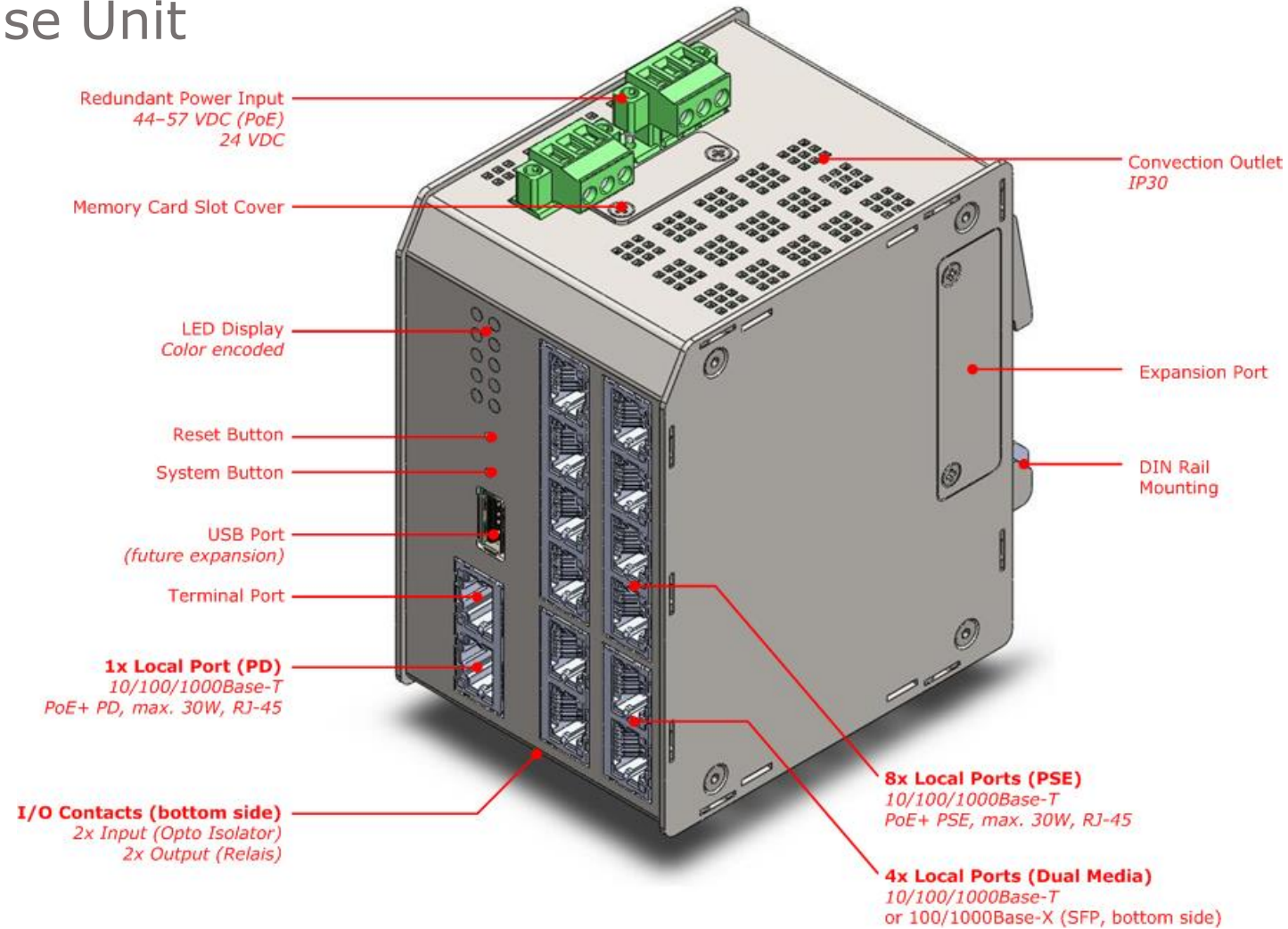

Profi Line Modular – Switch Generation 6

Expansion Modules

- „Click-On“ Installation
- Robust mechanical connection

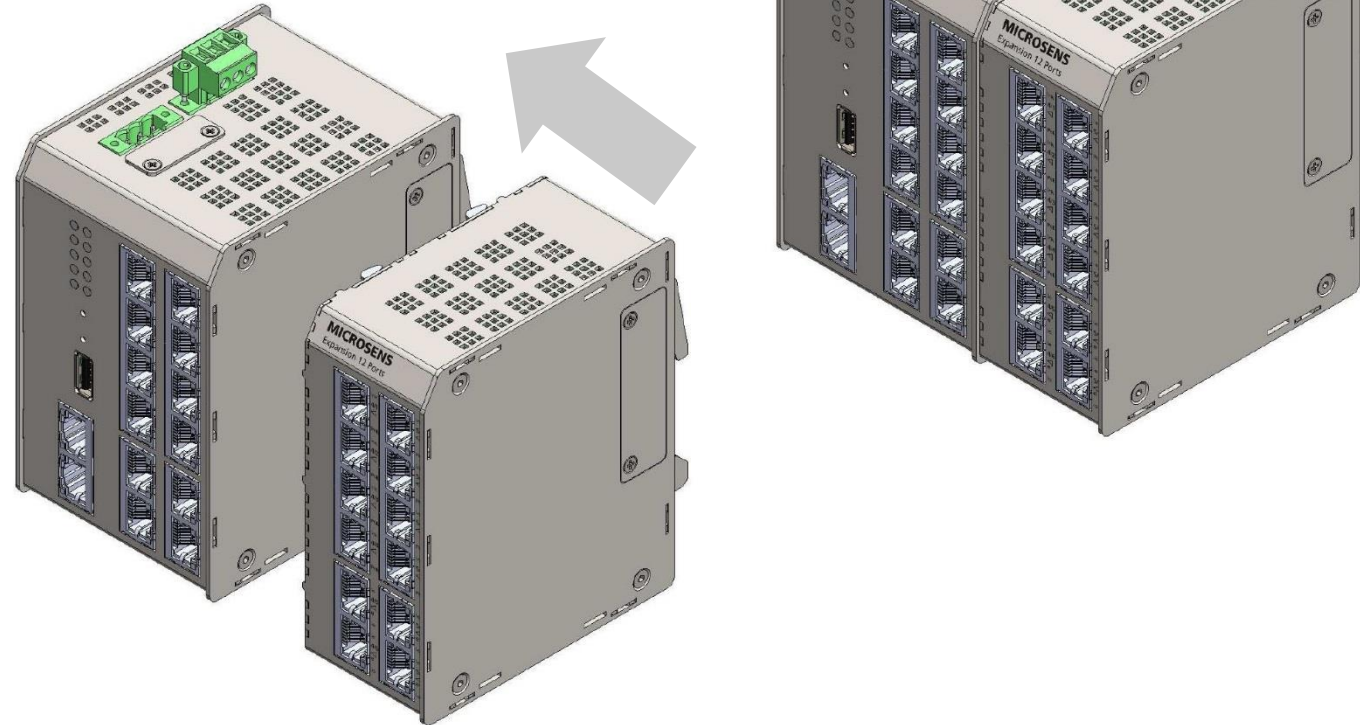

MICROSENS CONFIDENTIAL

Profi Line Modular – Switch Generation 6

Industrial Switch

Product Family

- Modularity for flexible expansion
- Basic Unit:
 - 9x 10/100/1000T RJ-45
 - 4x Dual Media (TP & SFP/SC)
- Expansion Modules:
 - 4x 10/100/100T RJ-45
 - + 2x Dual Media (TP & SFP/SC)
 - 8x 10/100/1000T RJ-45
 - + 4x Dual Media (TP & SFP/SC)
- Power Options:
 - 54 VDC with PoE+
 - 24 VDC without PoE

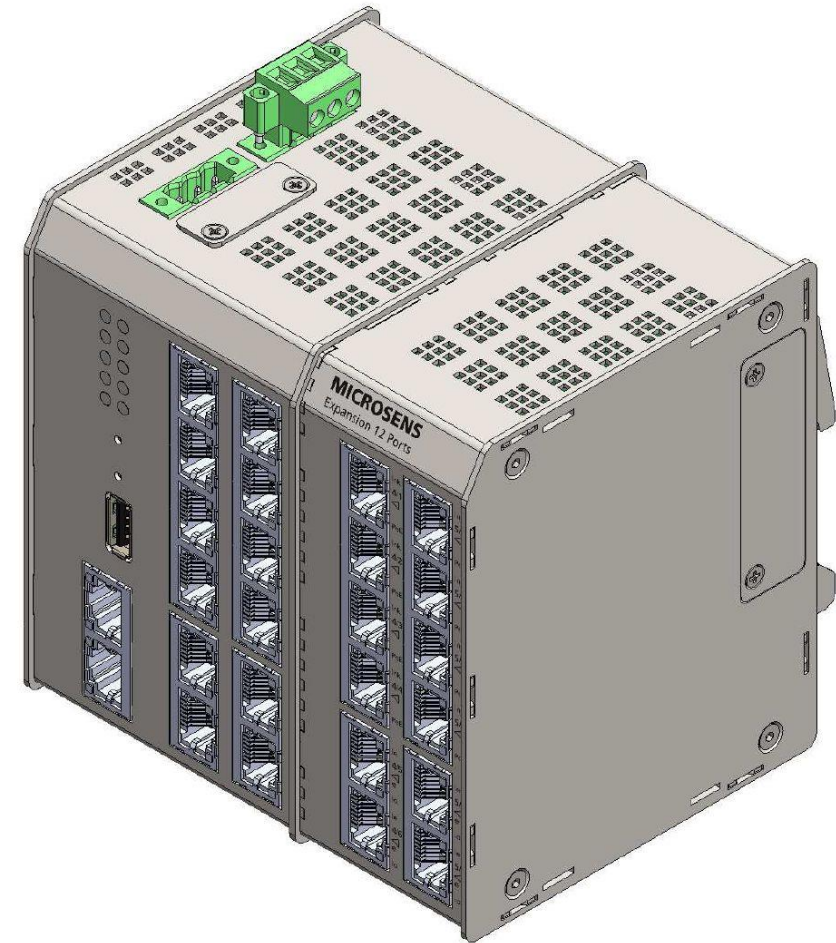

Profi Line + Switch Generation 6

Profi Line +

- All features of Generation 6
- Compact design
- 7 Gigabit ports
- Not modular
- Cost and size optimized



MICROSENS CONFIDENTIAL

Profi Line + Switch Generation 6

Profi Line +

- All features of Generation 6
- Compact design
- 7 Gigabit ports
- Not modular
- Cost and size optimized



Profi Line Rack – Switch Generation 6

Profi Line Rack Switch

- All features of Generation 6
- 25 Gigabit Ports
- 1U 19" rack mounting
- Ruggedized -40 to 75 degrees
- Fanless



Profi Line Modular/Rack

Características claves

- Full Gigabit Ethernet
- Diseño modular/Diseño Rack(19")
- base: 13 puertos
 - 13x puertos RJ-45/16x RJ45 con PoE+
 - 4x SFP/8x SFP
 - PoE+(30W) opcional High Power PoE(60Wattios)
- 1x PD para recibir alimentación de switches --con PoE
- Temperatura extendida(sin ventiladores)
- Tarjeta de memoria (servicio)



Energy
Efficient
Ethernet



Industrial Switches G6



Micro Switch G6 - Ruggedized

5(4)x 10/100/1000B-T + PSE (PoE+)
1(2)x SFP (Ring)



Profi Line+

4x 10/100/1000B-T + PSE (PoE+)
1x 10/100/1000B-T + PD (PoE+)
2x SFP Dual Media (Ring)
No Module Expansion Port



Profi Line Modular + 6 Ports Expansion

12x 10/100/1000B-T + PSE (PoE+)
1x 10/100/1000B-T + PD (PoE+)
6x SFP Dual Media (Dual Ring)



Profi Line Modular

8x 10/100/1000B-T + PSE (PoE+)
1x 10/100/1000B-T + PD (PoE+)
4x SFP Dual Media (Dual Ring)
Module Expansion Port



Profi Line Modular + 12 Ports Expansion

16x 10/100/1000B-T + PSE (PoE+)
1x 10/100/1000B-T + PD (PoE+)
8x SFP Dual Media (Dual Ring)

Microsens Generation 6

2 Solutions on the same platform



In-house and Outdoor installations



Installations for harsh environments

MICROSENS



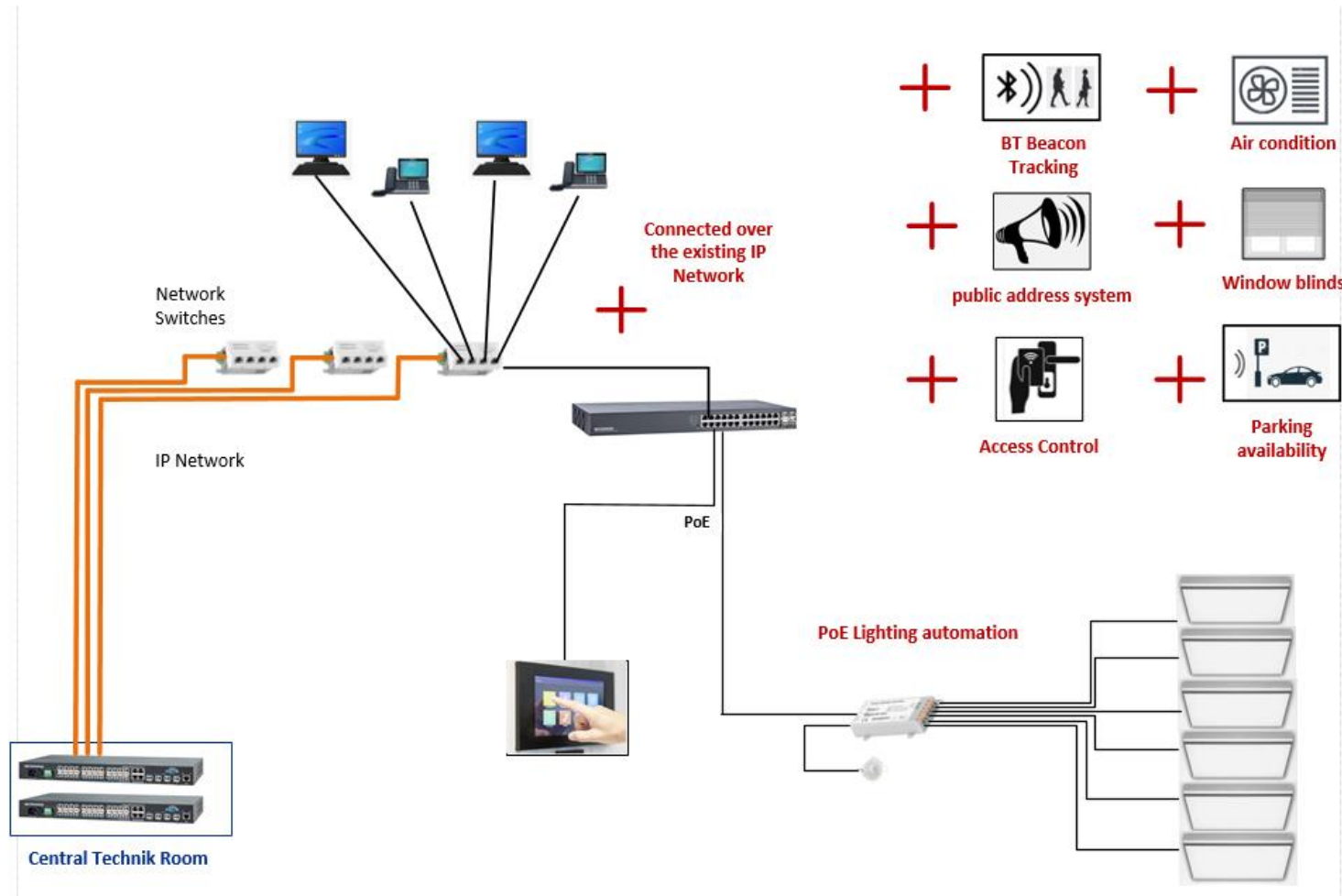

Advantages of Microsens Light automation

Latest and future-oriented technology

- Network Embedded Software Defined Automation - Alternative IP-Based solution to conventional Building Automation
- All IP based systems can be embedded into the Microsens infrastructure
- Solution grows automatically with IP innovations



Components components of PoE light automation

| Energy | Energy Control | External input | Input systems | Automated light | Intelligence |
|---|---|--|--|--|--|
|  |  <p>Gateway</p> |  |  |  | <p>Micro RTS</p> <p>Smart Building Manager</p> |

Structure of Microsens PoE lighting automation with I/O controller

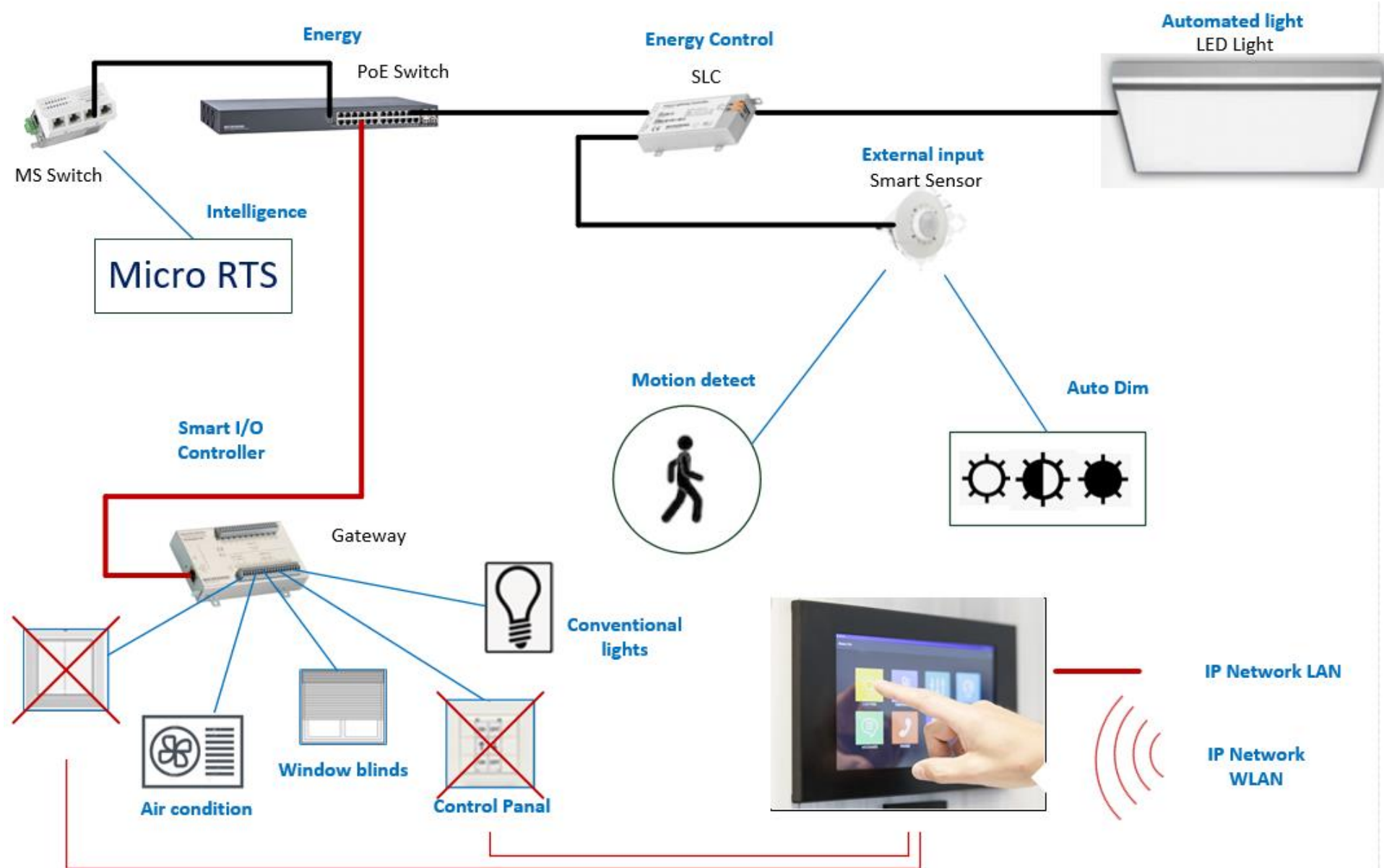

MICROSENS



SBR
Savunma

www.sbrsavunma.com.tr

